

Tubular 10' Dome Tent

TNT-TDT-10

The Tubular Dome Tent 10 is a branding opportunity and attention getter at any outdoor festival, exhibition or event. The Tubular Dome is constructed with 30mm silver anodized tubes and quickly assembles with snap button connectors. The canopy is custom printed, water and UV-resistant. The Tubular Dome Tent is made in the USA.

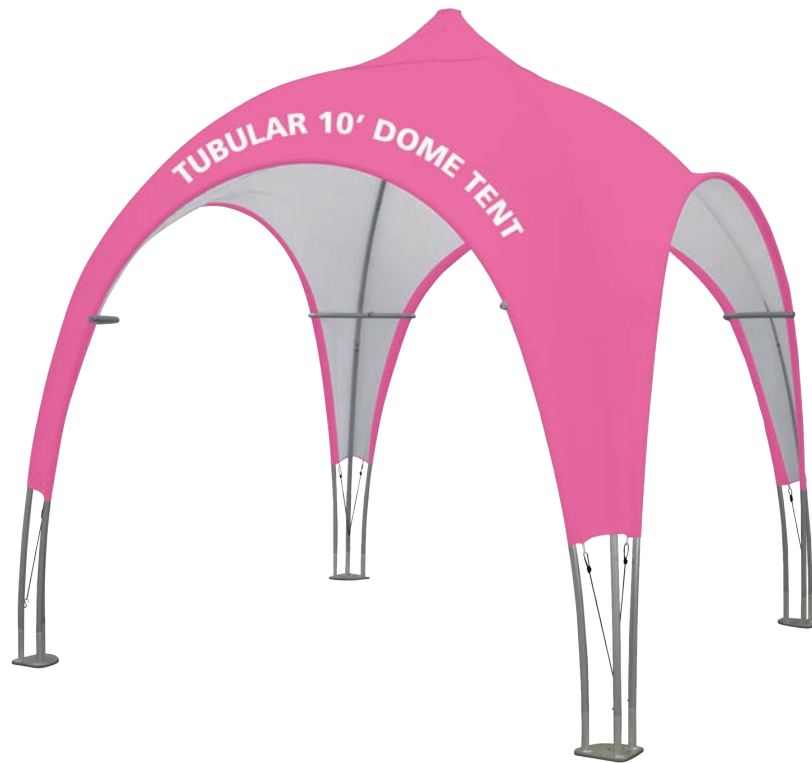

features and benefits:

- **NEW**
- Base size of 9.6' x 9.6'
- Aluminum tubular frame assembles quickly and easily with snap button connectors
- Custom printed canopy is water and UV-resistant
- Made in the USA
- Hardware kit includes frame
- Canopy kit includes canopy, frame and cases
- Easily disassembles and stores compactly in two OCE hard shell expandable cases
- Lifetime hardware warranty against manufacturer defects

dimensions:

Hardware

Assembled unit:
116" w x 122.37" h x 116" d
2946mm x 3108mm x 2946mm

Approximate weight (includes graphic):
53.06 lbs / 24.07 kgs

Shipping

Shipping dimensions - ships in 2 cases:
2 OCE cases: 66" l x 18" h x 18" h
1676mm(l) x 457mm(h) x 457mm(h)

Approximate shipping weight (with cases):
96 lbs / 43.54 kgs

Graphic

Total visual area:
Overall graphic size (qty 4): 137" w x 108.5" h

Top Triangle: 12.5" w x 9.5" h

Top Trapezoid: 32.5" h x 16" h

Dome: 137" w x 88.5" h

Pole Pocket (must be solid color):
131.75" w x 45.5" h

Please be sure to include a 2" bleed around the perimeter.

Refer to related graphic template for more information.

additional information:

Graphic material:
Outdoor canvas

Lifetime hardware warranty voided if damaged due to adverse weather conditions



www.display-setup-animations.com

We are continually improving and modifying our product range and reserve the right to vary the specifications without prior notice. All dimensions and weights quoted are approximate and we accept no responsibility for variance. E&OE. See Graphic Templates for graphic bleed specifications.

Parts Included		
Part Label	Qty	Part Code
30MM TUBE SECTION	x4	4S-TENT-T7
30MM TUBE SECTION	x4	4S-TENT-T10
30MM TUBE SECTION	x4	4S-TENT-T8
30MM TUBE SECTION	x4	4S-TENT-T5
30MM TUBE SECTION	x4	4S-TENT-T4
30MM TUBE SECTION	x4	4S-TENT-T6
30MM TUBE SECTION	x8	4S-TENT-T2
30MM TUBE SECTION	x4	4S-TENT-T1
30MM TUBE SECTION	x4	4S-TENT-T3
MOLDED PLASTIC PIECE FOR TC-30-E	x1	TC-30-E
FABRIC GRAPHIC WITH BUNGEE CORDS	x1	TNT-TDT-10-G



TOP VIEW

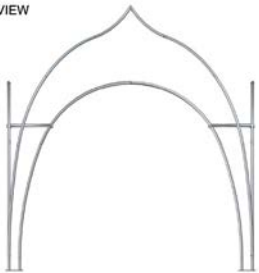

FRON VIEW

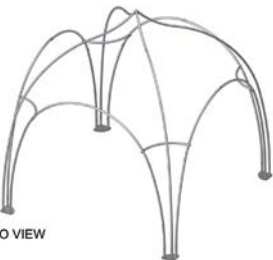

ISO VIEW

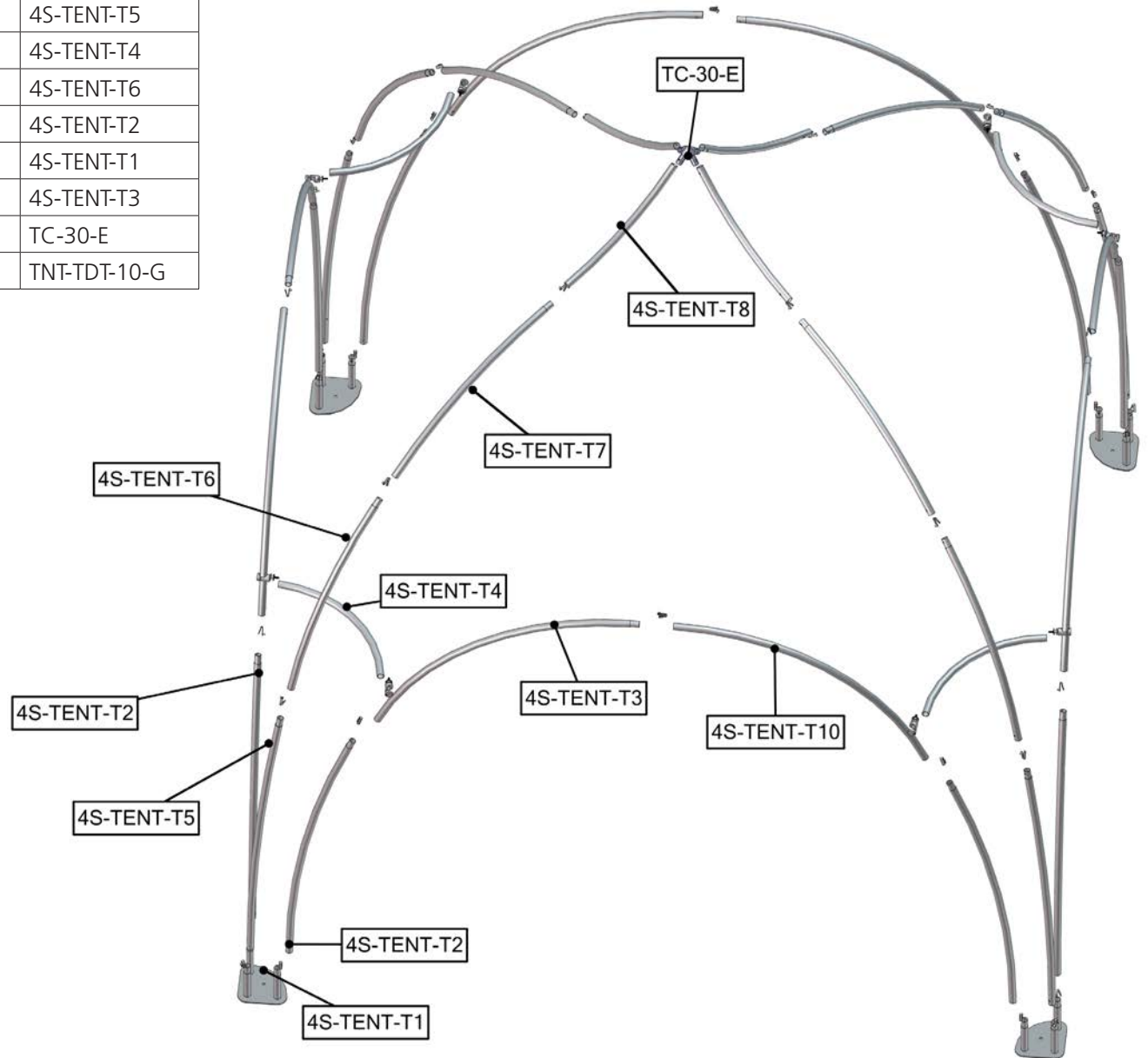

Step 1: Tube Assembly

Assemble unit by laying tubes flat on the floor. Connect the tube rails by pressing the push pin buttons in and sliding over (see detailed drawing below) following the number labels listed, 1 to 1, 2 to 2 and so on.

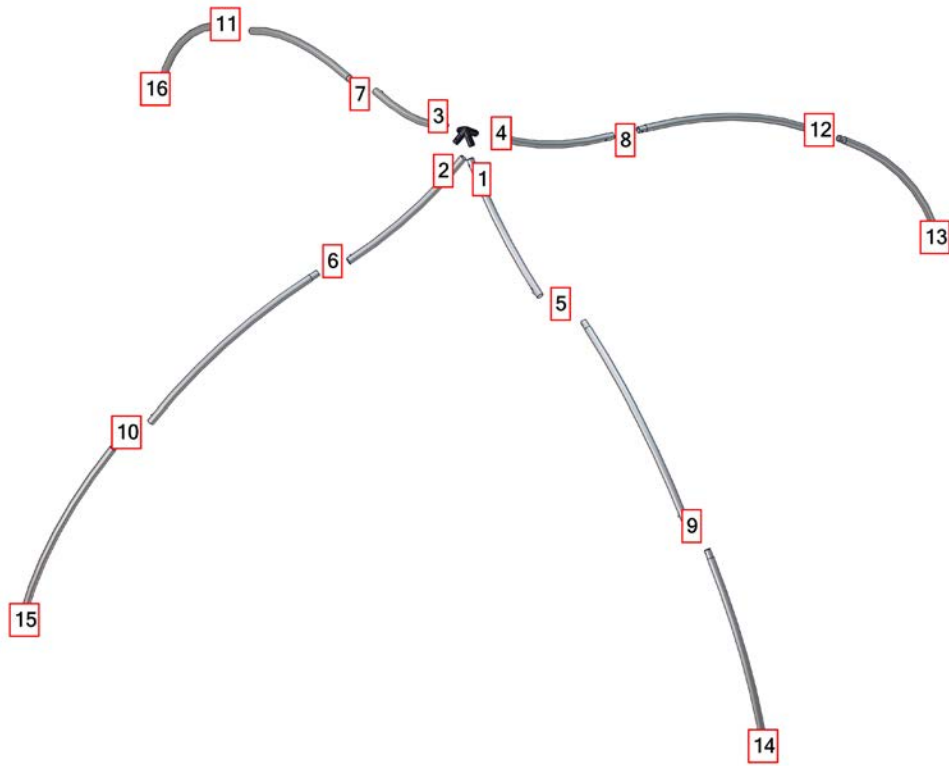

TUBE CONNECTION

CONNECT TUBE BY MATCHING NUMBER TO NUMBER, PRESSING PUSH PIN BUTTON AND SLIDE OVER

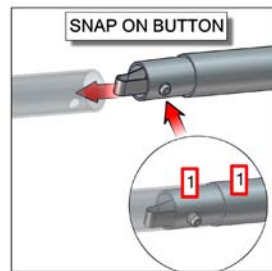

- ASSEMBLE FRAME AS SHOWN

Step 2: Graphic Attachment

Carefully remove the graphic from the bag. Drape graphic over the frame.

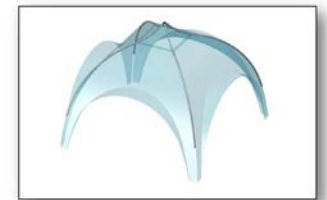
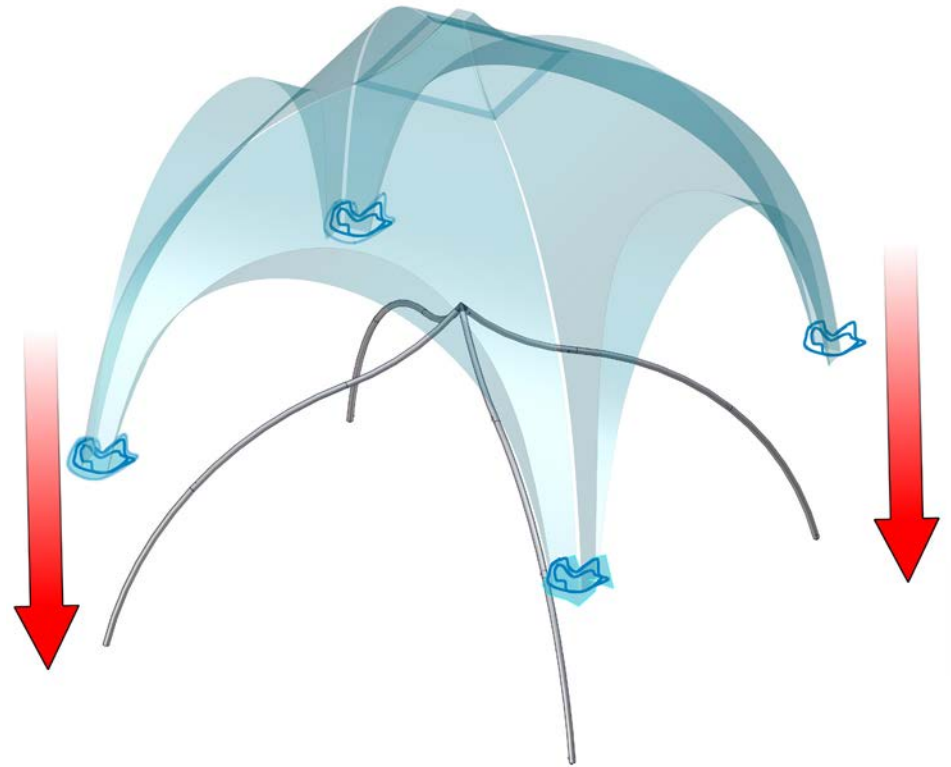

- PLACE FABRIC TO FRAME

Step 3: Tube Assembly

Assemble unit by laying tubes flat on the floor. Connect the tube rails by pressing the push pin buttons in and sliding over (see detailed drawing below) following the number labels listed, 1 to 1, 2 to 2 and so on.

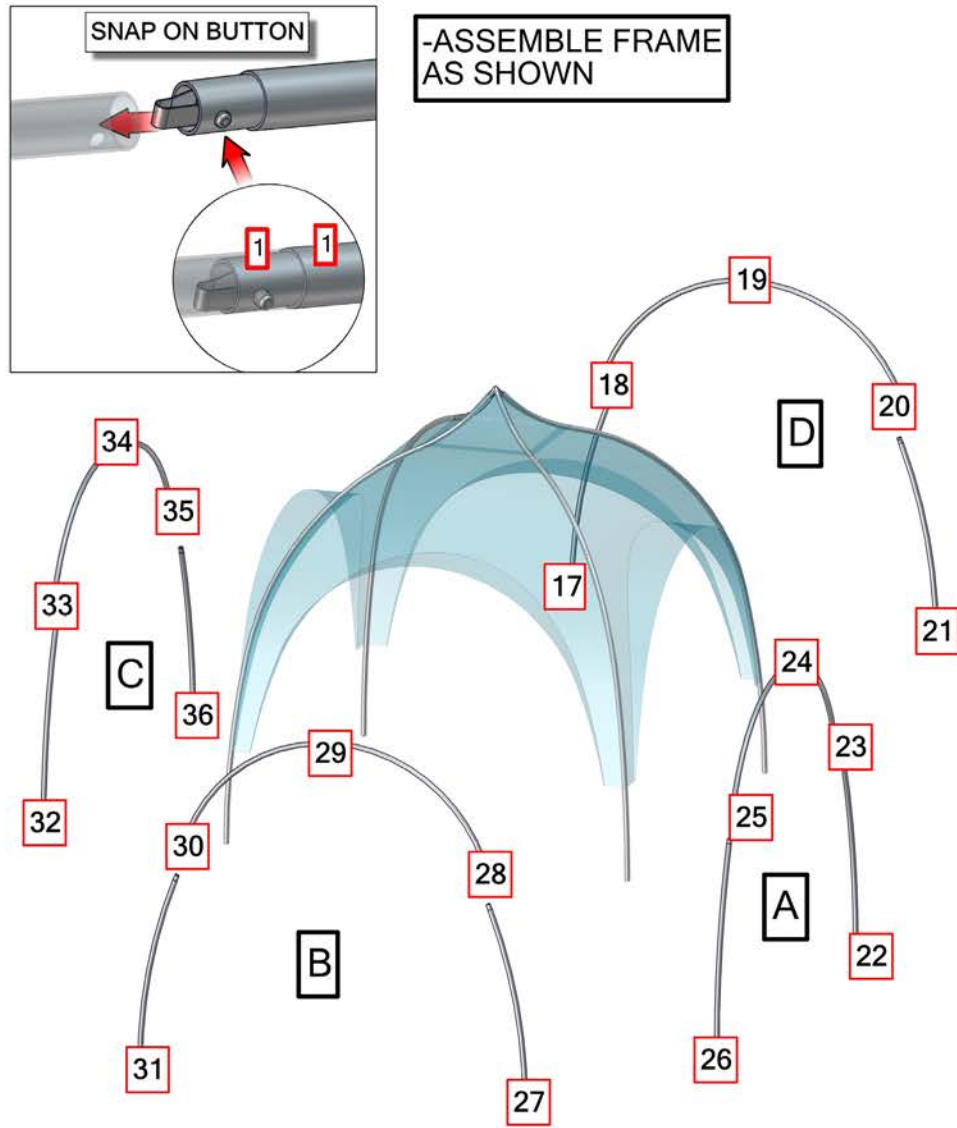

Step 4: Insert Tube Poles into Graphic Pockets

Carefully insert sections A, B, C, and D into fabric pockets. Insert tubes from each side and press snap on button at top middle to connect.

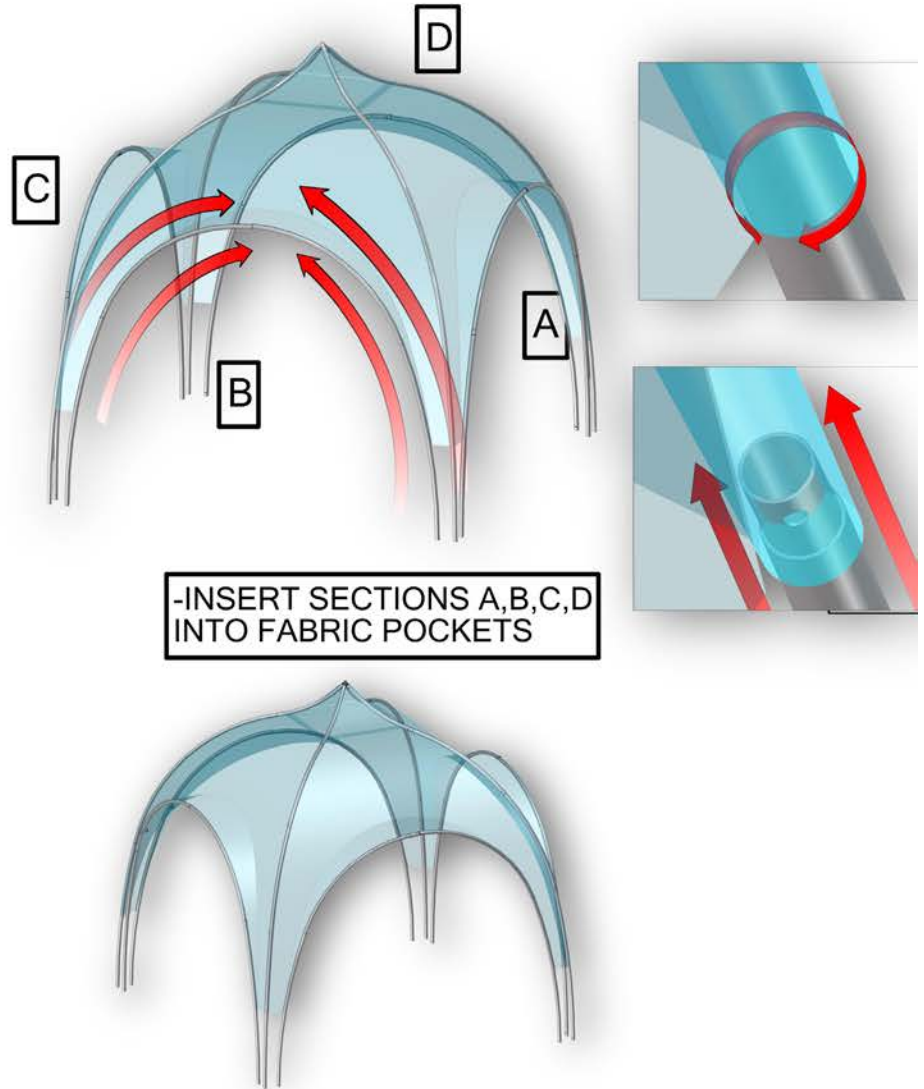

Step 5: Install Feet

Assemble feet by lifting up one side of the tent at a time and lining up the base. Connect the tube rails to each base by pressing the push pin buttons in and sliding over (see detailed drawing below).

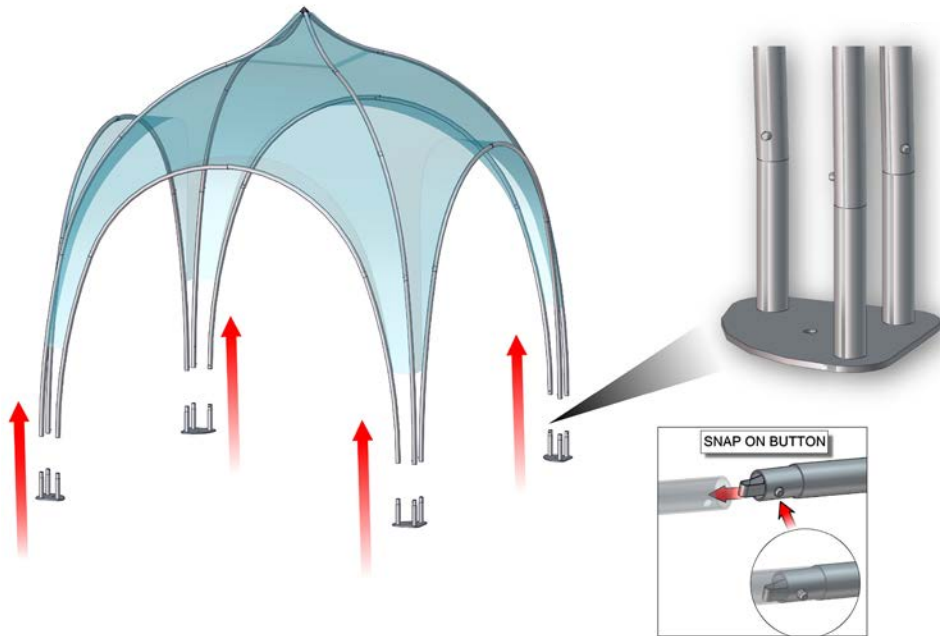

Step 6: Tube Assembly

To provide tension to Tent continue assembly by connecting tube rails in the corners. Connect tube rails just above corner tube connection point by using a 5mm T-handle. Do not overtighten. Continue with all four corners.

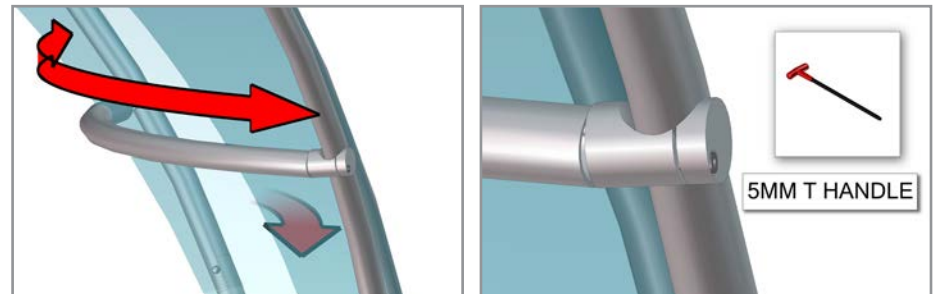

Step 7: Secure Graphic

Secure graphic to Tubular Tent using supplied S-hooks and bungee cords. Attach bungee hook each to graphic loop, two per corner. Loop around S-hook forming a V shape and secure S-hook in hole in tubing. Repeat for all four corners.

